

# AC Power Strips, Multi-Circuit – 20A Hardwired

## Description:

Power strip models ACS-2014-2C-HW and ACS-2014-1G-2C-HW are compact designs engineered for rack installation or standalone use. The two-circuit configuration is ideal for rackmount installations where some equipment has low current requirements and other equipment has higher power demands. Circuit one powers 3 duplex outlets; circuit two powers 8 single outlets. Rugged chassis (30"L x 2"W x 2"H) is manufactured with heavy gauge steel and finished in durable black powder epoxy paint. ETL Listed.

Multi-mount brackets allow for power strip installation in a variety of applications with outlet orientation facing forward, center or rear. Brackets are engineered with multiple mounting points and two types of hardware to facilitate easy power strip installation into cabinets with adjustable or fixed mounting rails or to wall or desk surfaces. The brackets can be mounted so they are exposed for easy access or concealed under the strip for aesthetically clean installation.

## Features:

- Steel chassis with black powder epoxy finish
- 30"L x 2"W x 2"H
- 20A power rating
- Two circuits
- Hardwired. Termination to 6-ft, non-metallic, flexible conduit (whip) with pigtail leads.
- Outlets:
  - Model No. ACS-2014-2C-HW: 3 duplex, 8 single
  - Model No. ACS-2014-IG-2C-HW: 3 isolated ground duplex, 8 isolated ground single
- ETL Listed (US and Canada)
- Made in USA

## A & E Specifications:

The power strip shall be ETL Listed Lowell model \_\_\_\_\_. Power rating shall be 20A 125VAC. Power strip shall include 3 duplex and 8 single (or 3 isolated ground duplex and 8 isolated ground single) outlets. Termination shall be via 6-ft. non-metallic, flexible conduit with pigtail leads. Strip shall install to racks with adjustable or fixed mounting rails and to walls and desk surfaces using multi-mount brackets and hardware provided.



Model No.	Description	Power Rating	Outlets	Termination	NRTL Listing	Size (L x W x H)
ACS-2014-2C-HW	AC 2-circuit Power Strip	20A 125VAC	14	6 ft. non-metallic conduit w pigtail leads	ETL	30" x 2" x 2"
ACS-2014-IG-2C-HW	AC 2-circuit Power Strip	20A 125VAC	14 (IG)	6 ft. non-metallic conduit w pigtail leads	ETL	30" x 2" x 2"

# AC Power Strips, Multi-Circuit – 20A Hardwired

## Front Panel Layout

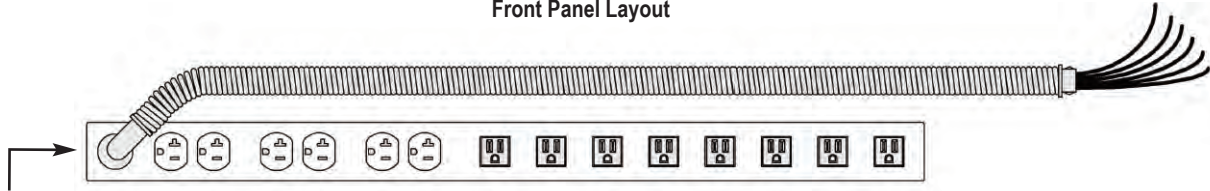

6-ft. non-metallic, flexible conduit (whip) rotates in any direction.

## Non-metallic Flexible Conduit can be Trimmed in the Field

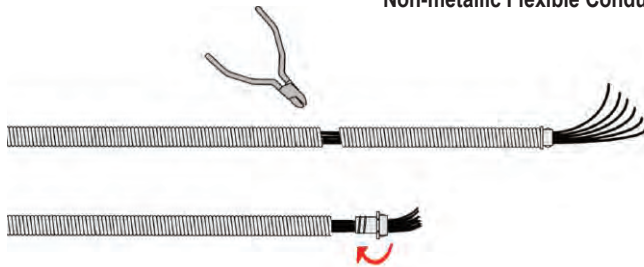

1. Snip reinforcing rib at desired length. Bend and carefully cut around conduit without cutting wires inside. Remove excess conduit.
2. Snip 2 or 3 ribs around the connector and remove connector from excess conduit.
3. Attach connector to shortened conduit length.

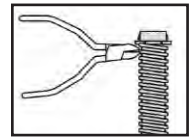

## Multi-Mount Brackets

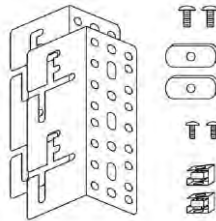

Brackets include multiple hardware sets for versatile installation (see Dia. A).

- (2) Brackets
- (2) 1/4"-20 x 1/2" screws
- (2) flat nuts
- (2) 10-32 x 1/2" screws
- (2) cage nuts

## (Dia. A) Power strip installation in racks using Multi-Mount brackets

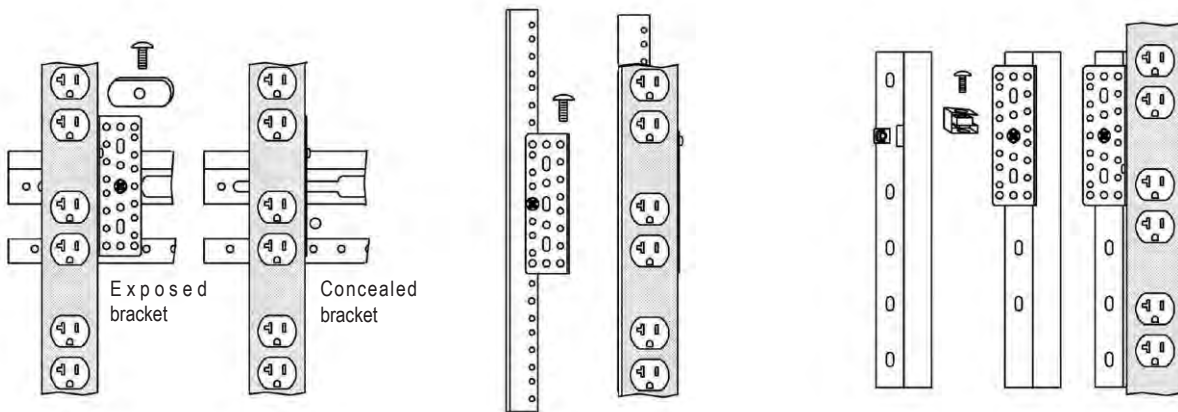

**Rack Type:** Adjustable Rail  
**Strip location:** Side of Rack (horiz. supports)  
**Mtg. Hardware:** Multi-Mount Brackets, 1/4"-20 screws, flat nuts

**Rack Type:** Adjustable Rail  
**Strip location:** Rear rail  
**Mtg. Hardware:** Multi-Mount Brackets, 10-32 screws

**Rack Type:** Fixed Rail  
**Strip location:** Rear Z-angle  
**Mtg. Hardware:** Multi-Mount Brackets, 10-32 screws, cage nuts